



Our Vision: A healthy, educated, self-sufficient community in Malawi

Inside this issue

<i>Disability & Health</i>	1
<i>New Office</i>	2
<i>Education</i>	2
<i>Staff News</i>	2
<i>Sam's Village</i>	3
<i>Staff News & Volunteers</i>	3
<i>Orphan & vulnerable</i>	3
<i>Fundraising Events</i>	4
<i>Thank yous</i>	4

DISABILITY

Our Partnership with 500 Miles continues to be very positive with more and more people being identified and treated. A number of outreach clinics are being held throughout our support area where 35 existing clients have been seen this year, along with 41 new clients assessed. Some of these days start at 6am and don't finish until 8pm due to the distances that have to be travelled. Our thanks to our dedicated team of Julie Ndalama and Thomas Lighton who work so hard on these outreach days. 500 Miles have now renamed days they spend with us, as 'Landirani days'! That is another way of saying a 'very busy day'!



In our last newsletter we told you how Yusuf (above) had taken his first steps with his prosthetic limbs. He is now proudly walking to school independently like any other child!



Outreach clinic patients (top) waiting for assessments at M'bang'ombe



Beth Sheehan from 500 Miles (right) assessing an existing young amputee client

HEALTH

M'bang'ombe Clinic have received two new nurses (right) Diana to work in the Maternity and Abiya in the Clinic. Since building the new maternity clinic in 2014 births have now risen from 20 per month to 86 this February! They are now asking for extensions, extra beds and additional staff housing! Our two community midwives will qualify at Easter and we hope the Government will post them here as soon as possible.



Man (above) with spina bifida receiving a hand knitted blanket which was knitted by one of our supporters, Jenny Holden.



Excitement by the local village when the container arrived on site!

NEW OFFICE

Our 40 ft container has been moved on to our new site at Njewa on the outskirts of Lilongwe. This will be used as a secure place to keep tools and materials. We will start developing the land by installing a borehole and fence initially before starting on Phase 1 of the office build.

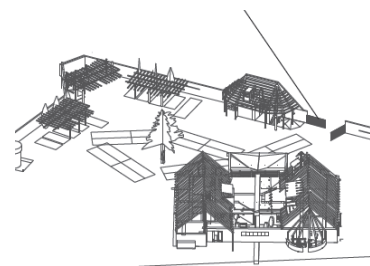

EDUCATION

Girls often leave school early for a variety of reasons one of which is early marriage. They don't have the opportunity to continue their education into Secondary School and a chance of making something of their future. We have been encouraging the older girls to stay at school by presenting 24 of them with dictionaries and rucksacks filled with school materials and underwear. Funds for this distribution was raised during a Malawi fundraiser at The Living Room last year. An additional 400 dictionaries were distributed within our schools, which were donated by Char-Char.



Joseph (above) is number one student in Std 1 at Chitsime school, we rewarded him with a bar of soap. He has a physical disability and this is a positive sign that our schools are educating inclusively.



Our thanks go to **Martin Mandulas'** family (right) for donating 5 bags of maize to M'teza CBCC feeding programme and books to the Library.



PRE-SCHOOL RENOVATIONS

Thanks to Mazars for donating money to renovate 5 of our pre-schools. We have one final one to complete. Now they have renovated classrooms, kitchen for cooking food for the feeding programme and new toilets. You can also see that inclusive education also runs through our Early Childhood Development with a young girl (far left) with albinism being taught at M'lumbwira CBCC (Community Based Childcare Centre).



STAFF NEWS



Thomas Lighton (left) is doing well in his new role and starting to learn how to use a computer. He is also studying to do his MSCE. If anyone would like to support him with school fees and books, please let us know.



Welcome back to full-time work with us, **Gift Banda** (right). He has completed his degree in Community Development and we are happy to have him back with the team.



Welcome Irene Mwale (bottom left) who is our new Librarian assistant at M'teza Community Library.

Staff of the month for 2015

Jan—February —Anold Mankhambila (right)
Feb—March —Kondwani Galanga (far right)



SAM'S VILLAGE

Noel and Mandy Hayes visited Sam's Village on 23rd March. Noel is funding the development in memory of his son, Sam who sadly passed away in September 2013. What an amazing legacy to leave in changing peoples future lives in a part of Malawi.



The buildings are slowly developing and we anticipate the workshop, kitchen and accommodation block will be completed by August. This year we will also build a new Reception area, new road way entrance, amphitheatre and relocate a central prayer house. Felix Dyre has joined us for a three month consultancy to put together our Training Programme which we aim to start in January 2016. We are forming a partnership with TEVETA (Technical, entrepreneurial and vocational education and training). The Training Village is not just for vocational training but an Educational Centre which models life skills training through permaculture. Man can work with the environment sustainably, with a balance of caring and sharing.



(above, left to right) roof of the new workshop; inside Trainee Accommodation; staff meeting in the Community Library; bottle wall compost toilet.



(left to right) Kondwani talking about permaculture; Mercy with dried Moringa leaf (miracle medicine); permaculture outside the CBCC

ORPHAN AND VULNERABLE CHILDREN (OVC)

'The Landirani Trust' now African Vision Malawi in UK, started 10 years ago because of the problems facing the orphans in our area. Many are left in the care of their grandparents, who have nothing to eat themselves, let alone something for other children. There has been some progress over the years, but there are still many orphans and their 'orphaned grandparents'. A few are below who Heather Palmer met in March, while in Malawi. February is the 'hungry month' and we provided some food and soap to orphan and vulnerable people in our area. This is a short-term solution and the long-term answer lies in multi-cropping and permaculture to provide food security; one of the key ambitions of Sam's Village.

(left to right) 12 year old girl with sole responsibility for her siblings; grandmother left with 4 grandchildren; elderly lady with no family; distribution of food to the most vulnerable.



 www.africanvision.org.uk

 www.facebook.com/africanvision

 www.youtube.com/landirani

 www.twitter.com/avmalawi

African Vision Malawi
P.O. Box 851A
Kingston Upon Thames
KT1 9FD

Phone: 020 8287 8169

Email:

info@africanvision.org.uk

Charity no 1113786



THANKS TO:

**GABRIELLE GARDENS
ROB TUCK GREENER
GARDENS**

**ST JOHNS CHURCH
LUCY BROMLEY
NOEL & MANDY HAYES
PROJECT4AFRICA
OUR LBC MEMBERS
OUR MALAWI TEAM**

**ALL SUPPORTERS
EPSOM COLLEGE
TOLWORTH GIRLS
SCHOOL**

**JO & MIKE CALVERT
SURBITON HIGH SCHOOL
THE CORNERHOUSE
JOLLY JUMPERS
KINGSTON PARISH
KNITTERS
ANN MILROY
ST MATTHEWS CHURCH
MAZARS
KINGSTON COLLEGE**

CELEBRATING 10 YEARS!

Thanks to a conceptual garden design submitted by 'Gabrielle Gardens' and 'Rob Tuck Greener Gardens' we are going to have a Garden at Hampton Court Flower Show in July. There is a hidden illusion in the central galvanised box! We are showing how permaculture outside the box is the alternative story to the 'inside' providing 'food security'. We are delighted to have Market Porter sponsoring the garden.



FUNDRAISING AND EVENTS

Future Events:

We have a free Gala evening for our 10 years in Malawi exhibition which shows a visual journey through photography and artwork of our progress. On **Tuesday 14th April** at The CornerHOUSE Community Arts Centre, Douglas Rd, Surbiton, KT6 7SB from 7—9pm. Complimentary welcome drink, snacks, raffle, music and film screening.

Lucy Bromley is running the London Marathon for us on 26th April. Funds will support our Disability project. If you would like to encourage her and support us, please go to : <https://mydonate.bt.com/fundraisers/lucybromley1>

10th Anniversary Quiz with a difference—we are inviting schools to hold a quiz night on **Friday 19th June** and compete with their own teams and also between other schools to receive a sur'prize' brought back from Malawi. If you know a school who would like to take part, please contact us for details.

Music event at SOAS University on **Friday 26th June** from 6—9pm with Kasai Masai headlining. During the day we are holding drumming and Zikomba Dance workshops. Tickets will be on sale shortly. Details to follow.



We currently have a group of 6 runners who have entered the British 10km London run on **July 12th**. We would love to have more join us. If you feel you would like a challenge please sign up before all the places go! If you would like to encourage the ones running you can donate at: <https://mydonate.bt.com/events/avm10krun/207530>

Our grateful thanks to Kingston College for the amazing Christmas Card designs. They are now designing a special 10th anniversary calendar for 2016!

Easy Fundraising—Such a brilliant idea! If you order your shopping online using Amazon and many others; then see if you can do it through **easy fundraising** and then money comes straight to us! <http://www.easyfundraising.org.uk/causes/avm>



30th March - 26th April 2015

Free Photography and Fine Art Exhibition

With photography and illustrations by
Gaynor Cook and Adam Newton